

YEAR 7 PRE-ORIENTATION DAY 2

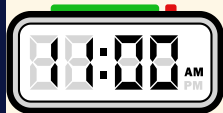

WELCOME TO MOUNT ERIN COLLEGE

When do I arrive, where to I go and what do I bring with me?



28/11/23



Administration Office



Arrive at 11 am on 28th November 2023.
Go to the General Administration Building to sign in
At 11:15am we will go to the Auditorium to start the day
You might want to bring a water bottle with you.

Mount Erin College has Four Houses.

WELCOME



We will go to the Auditorium to welcome you for the day.
We will answer any questions students have thought of since the first Pre-Orientation Day.

What will you do today?

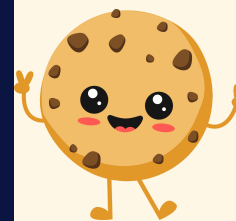

We will do some activities to help you get to know each other and our school, including some cooking and helping us learn more about you!

How will I find my way around the school?



Student helpers, teachers and Education Support Staff will guide you around the school today.
We will wait for you and make sure you know where to go next.
It is a big school and we know it can be hard to remember where things are at first.

What if I am not feeling well or need to go home?



If you need first aid, feel unwell or have an appointment, go to the front office.
They will be able to contact your parents for you.

Mount Erin College School Values

RESPECT

RESPONSIBILITY

RESILIENCE

We will talk about our school values Respect, Responsibility and Resilience throughout the day. We love to celebrate when students demonstrate these values.

Let us know if we can support you in any way.
We would love to help you participate in all activities.

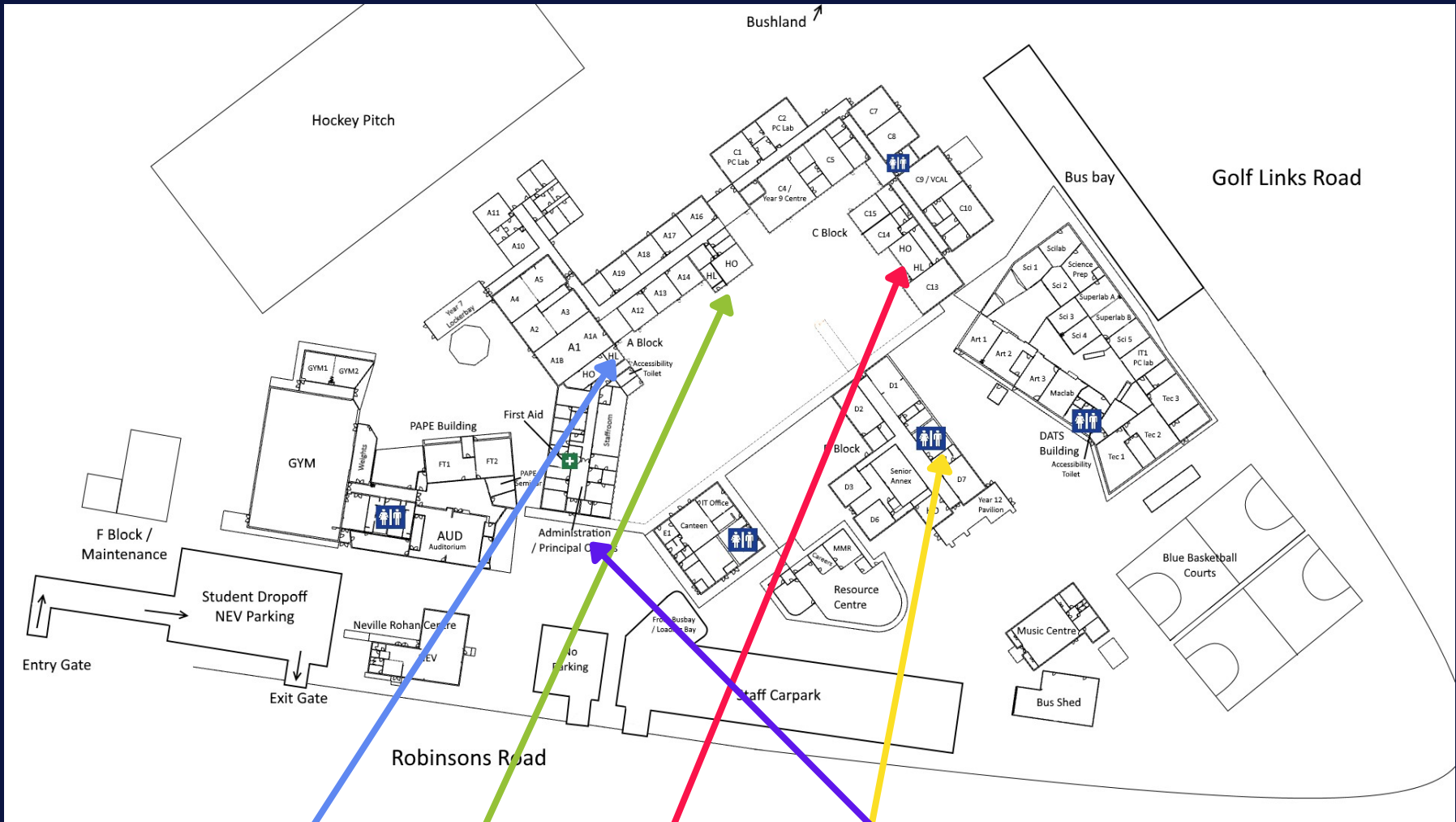

Toilets

Blue House

Green House

Red House

Yellow House

Administration

Office

Sign in here